

# Universal EasiTee

## Specifications

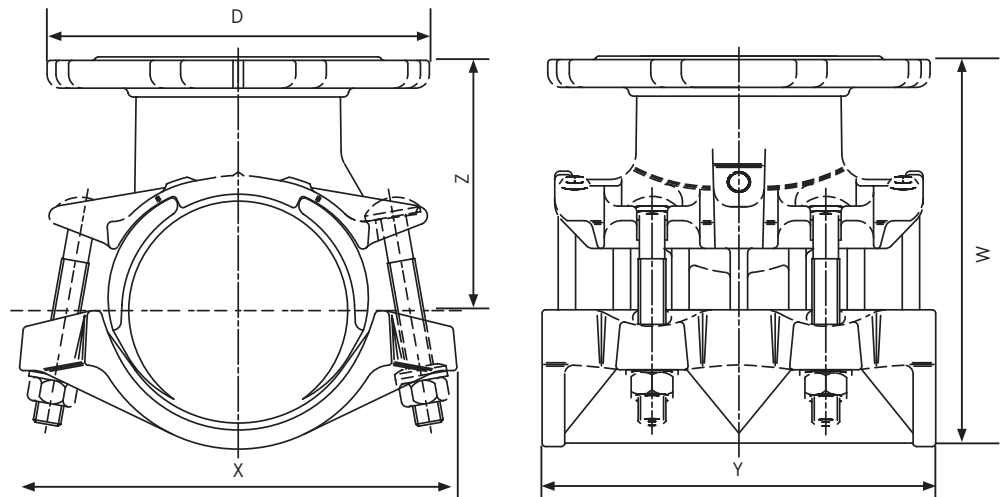

### EasiTee

| Pipe OD Size Range (mm) |       | Branch Drilling |          | Plain Mould No. | Branch Mould No. | Dimensions (mm) |     |     |     |     | Bolt Size No.-Size x length | Weight (kg) |
|-------------------------|-------|-----------------|----------|-----------------|------------------|-----------------|-----|-----|-----|-----|-----------------------------|-------------|
| Min                     | Max   | Nom             | Spec     |                 |                  | D               | W   | X   | Y   | Z   |                             |             |
| 85.4                    | 103.0 | 80              | PN 10,16 | 1792            | 1791             | 200             | 205 | 213 | 193 | 128 | 4-M16 x 110                 | 9.0         |
| 111.8                   | 129.4 | 80/100          | PN 10,16 | 1741            | 1740             | 200             | 228 | 227 | 252 | 146 | 4-M16 x 130                 | 10.5        |
| 165.2                   | 184.4 | 80/100          | PN 10,16 | 1743            | 1742             | 200             | 275 | 269 | 305 | 165 | 4-M16 x 130                 | 18.7        |
| 165.2                   | 184.4 | 150             | PN 10,16 | 1743            | 1742             | 285             | 275 | 269 | 305 | 165 | 4-M16 x 130                 | 20.9        |
| 215.9                   | 239.7 | 80/100          | PN 10,16 | 1745            | 1744             | 200             | 365 | 319 | 385 | 228 | 6-M20 x 140                 | 25.4        |
| 215.9                   | 239.7 | 150             | PN 10,16 | 1745            | 1744             | 285             | 365 | 319 | 385 | 228 | 6-M20 x 140                 | 28.0        |
| 215.9                   | 239.7 | 200             | PN 16    | 1745            | 1744             | 340             | 365 | 319 | 385 | 228 | 6-M20 x 140                 | 29.5        |
| 269.2                   | 293.5 | 80/100          | PN 10,16 | 1747            | 1746             | 200             | 424 | 368 | 462 | 260 | 6-M20 x 140                 | 49.1        |
| 269.2                   | 293.5 | 150             | PN 10,16 | 1747            | 1746             | 285             | 424 | 368 | 462 | 260 | 6-M20 x 140                 | 51.2        |
| 269.2                   | 293.5 | 200             | PN 16    | 1747            | 1746             | 340             | 424 | 368 | 462 | 260 | 6-M20 x 140                 | 52.3        |
| 269.2                   | 293.5 | 250             | PN 16    | 1747            | 1746             | 405             | 424 | 368 | 462 | 260 | 6-M20 x 140                 | 56.6        |
| 323.1                   | 349.0 | 80/100          | PN 10,16 | 1749            | 1748             | 200             | 478 | 439 | 534 | 290 | 6-M24 x 160                 | 58.7        |
| 323.1                   | 349.0 | 150             | PN 10,16 | 1749            | 1748             | 285             | 478 | 439 | 534 | 290 | 6-M24 x 160                 | 61.0        |
| 323.1                   | 349.0 | 200             | PN 16    | 1749            | 1748             | 340             | 478 | 439 | 534 | 290 | 6-M24 x 160                 | 62.5        |
| 323.1                   | 349.0 | 250             | PN 16    | 1749            | 1748             | 405             | 478 | 439 | 534 | 290 | 6-M24 x 160                 | 66.0        |
| 323.1                   | 349.0 | 300             | PN 16    | 1749            | 1748             | 460             | 478 | 439 | 534 | 290 | 6-M24 x 160                 | 66.0        |

## Materials & Relevant Standards

### Bolt Torque/Spanner Details:-

M16 = 95 to 110Nm/A/F 24mm  
M20 = 150 to 165Nm/A/F30mm  
M24 = 285 to 300Nm/A/F36mm

### Housing

Flanged Housing - Ductile Iron to BS EN1563:1997  
SYMBOL EN-GJS-450-10

Plain Housing - Ductile Iron to BS EN1563:1997  
SYMBOL EN-GJS-450-10

### Bridging Plate

Ductile Iron to BS EN1563:1997  
SYMBOL EN-GJS-450-10

### Gasket

Grade E, 60 IRHD EPDM BS EN681-1:1996

### Bolts/Nuts/Washers

**Bolts** - Steel to BS EN 10083: Part 1:1991 Grade 2.C.22  
Steel to BS EN ISO898-1 2009 property class 4.8.

**Nuts** - Steel to BS 4190:2001 Grade 4

Spherical Washers - Pearlite Malleable Iron  
to BS EN 1562:1997 Symbol EN-GJMW-400-5

**Washers** - Stainless Steel to BS 1449: Part 2:1983  
Grade 304 S15

### Coatings

**Flanged Housing** - Rilsan Nylon 11 to WIS 4-52-01 (Part1)

**Plain Housing** - Rilsan Nylon 11 to WIS 4-52-01 (Part1)

**Bridging Plate** - Nylon 11 to WIS 4-52-01 (Part 1)

**Bolts & Nuts** - Flurene coated

### Approvals

All water contact materials are WRAS approved for use with potable water.  
Full product is WRAS approved for use with potable water.

Every effort has been made to ensure that the information contained in this publication is accurate at the time of publishing. Crane Ltd assumes no responsibility or liability for typographical errors or omissions or for any misinterpretation of the information within the publication and reserves the right to change without notice.